

MANUFACTURER'S 12 MONTH LIMITED WARRANTY

Your Joyzze product is warranted against manufacturer's defects for one year from the date of purchase. If your Joyzze clipper is determined to be defective in material or workmanship during the warranty period, Joyzze will repair or replace the product. Customer only pays shipping. Return the defective product along with proof of purchase, enclose a return fee of \$15.00 USD, and a note explaining the problem to:

Joyzze Service, P.O. Box 440098, Kennesaw, GA 30160.

Modifications or repairs not made by Joyzze™: accidental damage, misuse, neglect, use of unauthorized attachments or parts are not covered by this warranty.

For customer service please e-mail to info@JOYZZE.com or call toll free 877.456.9993 (U.S. and Canada)
For outside U.S. and Canada, please dial +1 877.456.9993

JOYZZE
JOY OF GROOMING MADE EASY™

JOYZZE USA, INC.

📍 P.O. Box 440098 Kennesaw, GA 30160 USA

☎ 877.456.9993 (877.4JO.YZZE)

🌐 JOYZZE.com

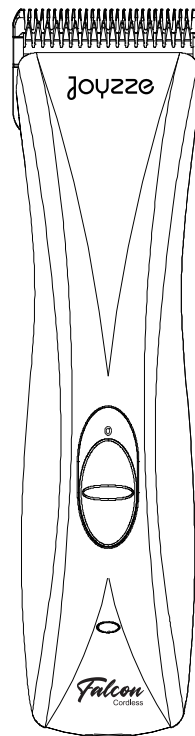

JOYZZE
JOY OF GROOMING MADE EASY™

Falcon Clipper User & Care Manual

*Model: JZA-2 Cordless
JZA-3 Corded*

NOTE:

Whenever using an electrical appliance, it is vital to follow basic safety precautions, including the following:

Read and understand all instructions before using the appliance.

SAFETY:

Neglecting the safety instructions and regulations mentioned in this manual may result in equipment malfunctions or serious personal injury.

1.1 Personal

Only individuals experienced in handling the animals to be clipped should operate the clipper.

Children are not permitted to operate the equipment.

Only reliable personnel are permitted to operate the clipper. Individuals whose reactivity is impacted by drugs, alcohol or pharmaceuticals should not operate the equipment.

1.2 Symbols and Warning Notes

The operating instructions contain various symbols indicating possible hazards or technical information that, if not followed, may result in personal injury, material damage, or uneconomical operation.

HAZARD SYMBOLS: **WARNING/DANGER!**

Avoid a possibly hazardous situation. Not avoiding such situations can result in severe injury and even death.

INFORMATION SYMBOLS:**NOTE! IF NOT FOLLOWED, CAN RESULT IN OPERATIONAL STOPPAGES OR DAMAGE.**

1.3 Intended Usage

The equipment is exclusively designed and intended for the specific use described in this manual.

The equipment is intended for use only on dogs, cats, cattle, and horses.

Compliance with all instructions in this manual is part of the intended use.

Any other use of the equipment is not recommended.

The clipper must only be operated with the provided power supply unit.

The clipper is not designed to be use on humans

1.4 Personal Protective Equipment

Anti-slip sleeves are included to prevent slipping.

1.5 Power Supply

 **DANGER!**

To reduce the risk of electric shock:

Do not touch the device if it falls into water. Immediately unplug it from the outlet.

Do not use while bathing or showering.

Do not place or store the appliance where it may fall or be pulled into a tub or sink. Do not place it in or drop it into water or other liquids.

Always unplug the adapter from the outlet immediately after use, except when charging.

Unplug the adapter before cleaning.

 **WARNING!**

To reduce the risk of burns, fire, electric shock, or injury to persons:

Never leave the clipper unattended when it is plugged in.

This clipper is not intended for use by persons (including children) with reduced physical, sensory, or mental capabilities or lack of experience and knowledge, unless they have been given supervision or instruction concerning use of the clipper by a person responsible for their safety. Children should be supervised to ensure that they do not play with the equipment.

Use the clipper only for its intended use as described in this manual. Do not use attachments not specified by the manufacturer.

Never use the clipper if the cable or outlet is damaged or if it does not work properly after falling, sustaining damage or landing in water.

Take the clipper to a service center for inspection and repair.

Keep the cord away from heated surfaces.

Keep the air openings free of lint, hair, and similar objects.

Never drop or insert any object into any opening.

Do not use outdoors or operate while aerosol (spray) products are being used.

Do not use this appliance with a damaged or broken comb, as it has the potential to result in injury.

First, insert the plug into the device before plugging it into the outlet. To disconnect, turn all controls to the off position and then remove the plug from the outlet.

WARNING! KEEP THE DEVICE DRY.

1.6 Animals

The appliance is intended for trimming purposes only.

WARNING!

The noise of the clipper might disturb some sensitive animals. A kick, attack, or weight of the animal can cause serious injuries. Therefore:

Only individuals experienced in handling animals should clip them.

The animal should be fixed and calmed sufficiently before clipping.

Work carefully.

Unauthorized individuals are not allowed to approach the clipping area.

Do not charge, install or leave the device in places where it may be exposed to damage from an animal or weather effects.

1.7 Clipping Blades

WARNING!

Moving blades and sharp edges of the blades can cause injuries to the skin. Therefore:

Work carefully.

Avoid any contact with the moving blades.

1.8 Battery and Charging Station

WARNING!

Do not crush, heat, incinerate, short circuit or immerse in any liquid or the battery may vent or rupture.

Do not insert metallic objects into the battery cavities of the charging station.

To clean external parts of the charging station, use a soft brush or damp cloth. Do not use harsh abrasives, detergents, or solvents.

Do not use the power adaptor designed for the Joyzze Falcon clipper to attempt to charge any other battery.

The battery contains an overload protection feature. In extreme cases, overload protection may cause the battery to become inoperable.

Do not attempt to power any product other than the Joyzze Falcon clipper with this lithium-ion battery.

For maximum battery life, do not store clipper, charging station under 50°F or over 104°F.

Do not expose the clipper, charging station to excessively damp conditions.

Take care not to drop the clipper, charging station. Do not attempt to use a damaged charging station or clipper.

1.9 Children

WARNING!

Never leave the clipper unsupervised and use it very carefully when children or individuals who cannot assess the dangers are nearby.

Children are not permitted to operate the equipment.

Children should be supervised to ensure that they do not play with the clipper.

GENERAL

This manual is designed to help you handle the machine safely and efficiently. Before operating the equipment, carefully read and understand these instructions.

The safe operation of the equipment requires compliance with all safety and operating information in this manual.

Keep this manual at all times. If you hand over the equipment to other individuals, provide them with this manual.

1.1 Guarantee Condition

The guarantee conditions are included in the manufacturer's general terms and conditions.

1.2 Customer Service

For technical information, our customer service and authorized service centers are available to you.

In addition, our staff is interested in new information and experiences resulting from the operation, which could be useful for improving our products.

1.3 Limitation of Liability

All data and information in this manual were arranged with consideration of current standards and regulations, the state of the art, and our realizations and experiences over many years.

The manufacturer assumes no liability for disadvantages due to:

Non-compliance with the instruction manual.

Operation of the clipper for unintended use.

Use of unauthorized personnel.

Technical modifications.

Use of unauthorized spare parts.

The actual scope of delivery may differ from specially designed models, additional ordering options, or due to the latest state of the art from the annotations and illustrations described here.

This product has been developed and assembled using the best individual components available. It is designed to provide longevity and high performance.

If spare parts are used during the life of this product, please ensure that they are genuine Joyzze parts. Failure to use genuine Joyzze spares may reduce the performance of this precision-engineered product and will void any warranty claim.

FAILURE TO CHARGE

Make sure the outlet is working and plugs are well seated in the clipper and outlet. If clipper still fails to charge return for maintenance (see Manufacturer's 12 Month Limited Warranty).

LITHIUM-ION BATTERY USE, STORAGE, AND DISPOSAL (CORDLESS VERSION ONLY)

1. The Joyzze Falcon Cordless Clipper (JZA-2) comes with a rechargeable lithium-ion battery inside.

The battery does not develop a "memory effect".

You can return the clipper to the charging station at any time for a full charge, or even use the battery before a charge cycle is complete.

Like most rechargeable batteries, lithium-ion batteries perform best when used frequently.

2. For maximum battery life, if the clipper will be in storage from several months or longer, store with a partial battery charge of about 40%.

3. Store the clipper in temperatures between 50°F/10°C and 104°F/40°C. Do not store in damp conditions.

4. Do not place the clipper near heat vents, radiators, or in direct sunlight. Optimal charging requires stable temperature conditions while sudden increases in temperature will reduce battery charge capacity.

5. Initially, new lithium-ion batteries, unused for a period of time, may not accept a full charge. This is normal and does not indicate a problem with the battery or charger. The battery will accept a full charge after several cycles of clipper use and recharging.

6. When not in use for extended periods, disconnect the adapter cord from the AC outlet.

7. Many factors influence lithium-ion battery life. A battery that has received heavy use or is more than a year old may not give the same run-time performance as a new battery.

8. Check with your municipal solid waste organizations for details on lawful disposal and recycling options.

CLIPPER REPAIR SERVICE

Please call Joyzze Customer Service at 877.456.9993 or email us at info@joyzze.com for assistance resolving any issues you're experiencing with your Joyzze Clipper. If your issues cannot be resolved over the phone or via email we will assist you with the return for repair service process. If you wish your clipper to be serviced as well it should be carefully packed and mailed either Parcel Post Insured or U.P.S. to:

Joyzze P.O. Box 440098, Kennesaw, GA 30160.

See Manufacturer's 12 Month Limited Warranty, Warranty Card, and Repair Service Instructions.

Clipper Body (with #10 A5 style blade*1)

Model	JZA-2 Falcon Cordless
Input	9V \Rightarrow 3A
Power	30W Max
Speed (2-Speed)	3200 - 3600 SPM
Noise	\leq 70 dB

Power Adaptor (Input: 100-240V \sim 50/60Hz; Output: 9V \Rightarrow 3A)

Universal	(Item: #0924)
-----------	---------------

* Different adapter & plugs in the packaging for different countries and regions.

Battery

Li-ion Battery	7.4V 2600mAh
Charging Time	120 minutes
Running Time	200 minutes (Depending on the speed)

Package Includes

Item	JZA-2 Falcon Cordless	JZA-3 Falcon Corded
Clipper Body	●	●
Power Adaptor	●	●
Lubricant Oil	●	●
Cleaning Brush	●	●
Manual	●	●
Non-Slip Sleeve	●	●
Charging Station	●	/

Model	JZA-3 Falcon Corded
Input	9V \Rightarrow 3A
Power	30W Max
Speed (2-Speed)	3200 - 3600 SPM
Noise	\leq 70 dB

Charging Station (Item: #0986)

Input	9V \Rightarrow 3A
-------	---------------------

* Only the JZA-2 Cordless model comes with a Charging Station and Built-in Battery.

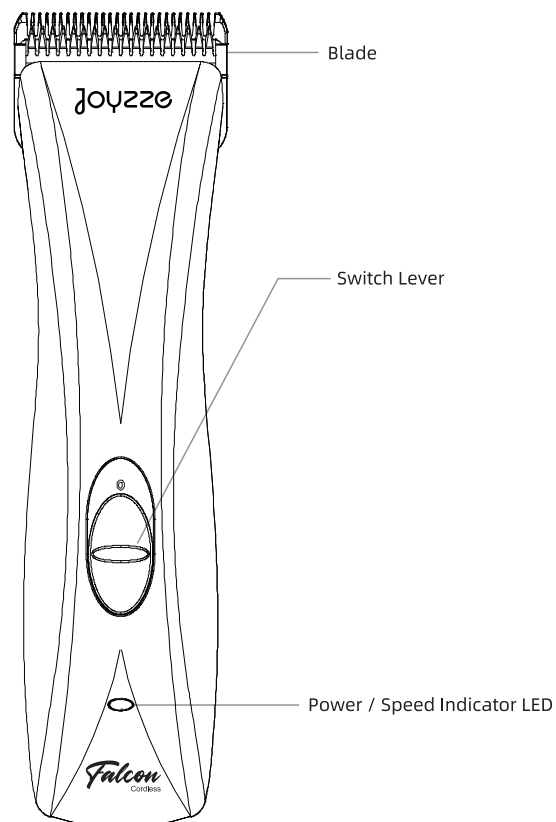

Falcon

Accessories:



* Adapter & plugs may the packaging for different countries and regions.

Item pictured may differ from actual product.

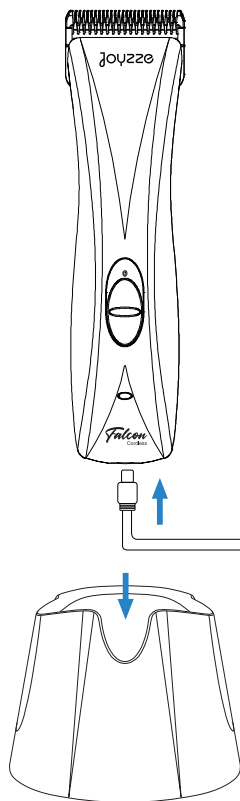

JZA-2 FALCON CORDLESS

1. Push the lever switch and adjust it to the desired speed position to use the clipper.
2. When the battery level is sufficient, the clipper can be operated in cordless mode.
3. When the battery level is very low or there is no time to charge the clipper, it can be temporary operated with a cord like the corded version.

* The battery will be charged simultaneously when the clipper operated with a cord.

** The charging time will be longer if the clipper is operating

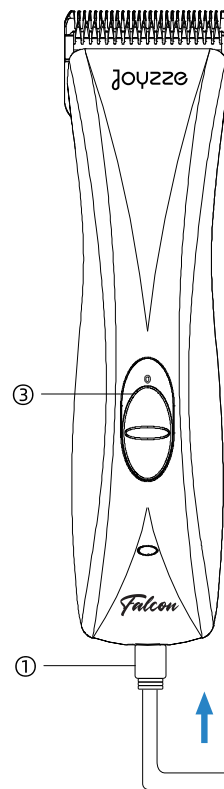

JZA-3 FALCON CORDED

1. Connect the power adaptor to the wall outlet.
2. Push the switch lever and adjust it to the desired speed position to use it.

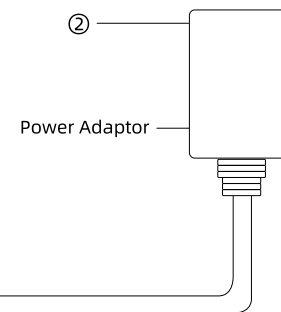

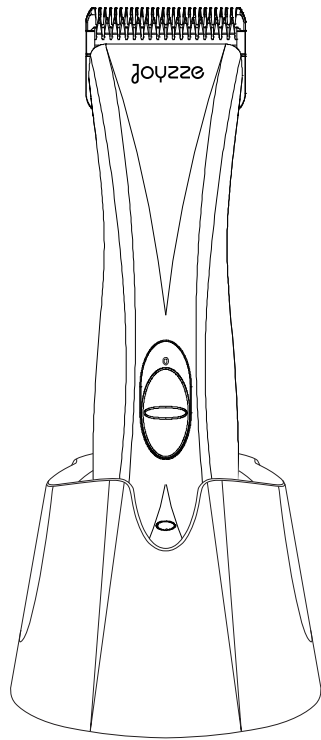
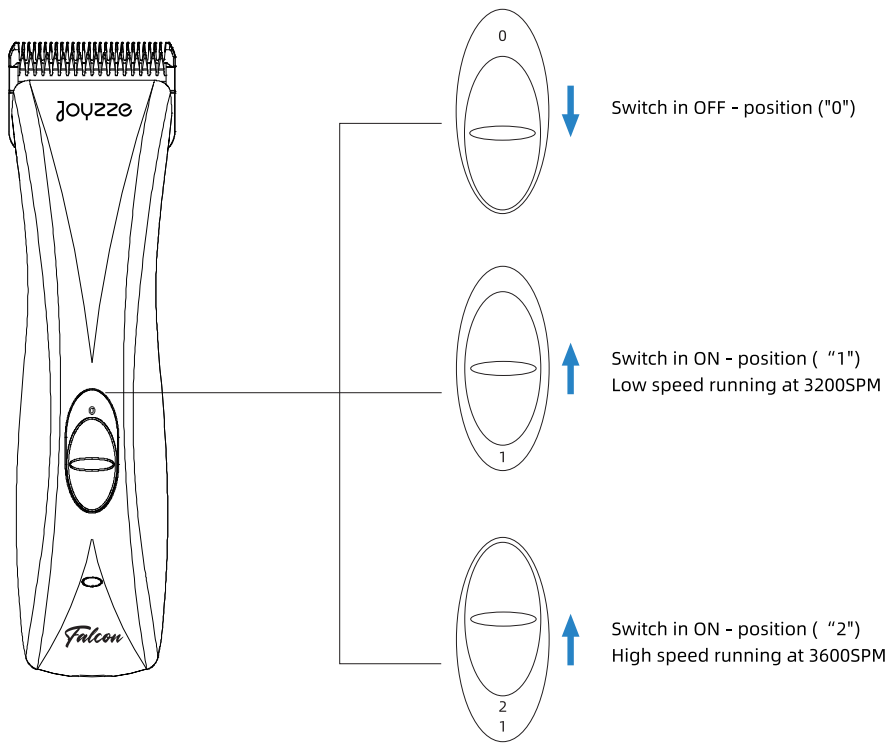

Falcon Corded (JZA-3)

When operating:

Green light always on: Low speed running at 3100SPM

Green light flashing: High speed running at 3800SPM

Falcon Corded / Cordless (JZA-2)

When cordless operating:

Red light fast flashing 3 times:

The battery power is exhausted, the clipper needs to be charged or converted into a corded operation.

Green light always on:

Low speed running at 3200SPM

Green light flashing:

High speed running at 3600SPM

Red light flashing:

The battery is low, prompting that the clipper needs to be charged or converted into a corded operation.

Red light fast flashing 3 times and lights off:

The battery power is exhausted, the clipper is turned off automatically.

When corded operating: The red light is always on.

When charging:

The red light is always on when the clipper is charging, and the green light is always on after the clipper is fully charged.

◆ **BLADE INSTALLATION**

Insert the blade slot into the blade latch, and fold it on to the switched-on clipper by light pressure, press the blade down and hear a "click".

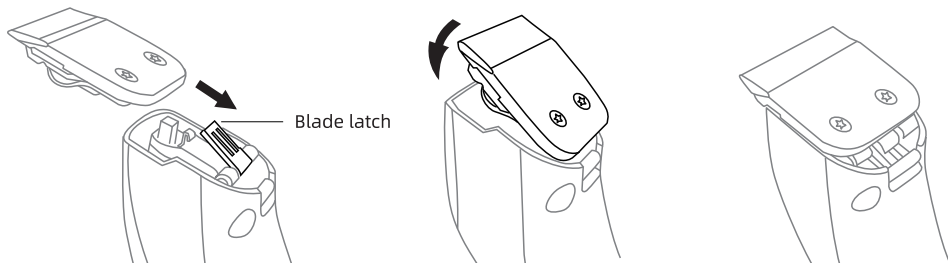
◆ **BLADE REMOVAL**

Push the **release button** to the end, at the same time, fold the blade backward, pull the blade out of the latch with another hand to take off the blade.

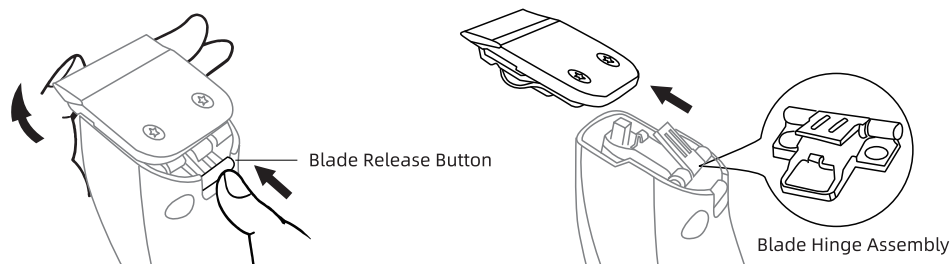

⚠ CAUTION: Turn OFF the clipper and disconnect from outlet before performing maintenance.

◆ **BLADE REMOVAL** ⚠

If the blade latch is accidentally closed, please use a flat screwdriver, insert into the latch gap and pry it up as figure suggests.

CAUTION is advised to not damage any components while conducting the suggested method above.

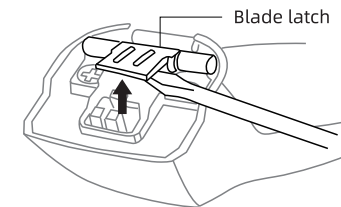
◆ **BLADE MAINTENANCE**

1. **Blade cleaning:** Move the shear blade within a short range and use the brush to remove hair that is stuck between the shear blade and the comb blade.

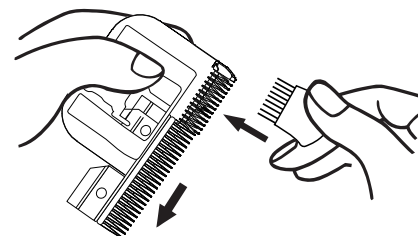

2. **Blade oiling:** The blades must be oiled before, during and after every use. When the blades of the clipper are leaving stripes, this is a signal that oil is required.

Place 1-2 drops of lubricating oil ahead and laterally on the blade shown below. Wipe off the excessive oil with a smooth, dry cloth.

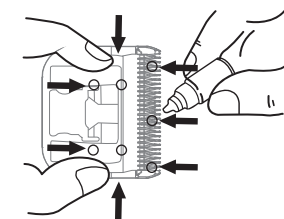

In order to achieve optimal clipping performance and enhance the longevity of both the clipper and the blade, it is important to apply a thin coat of oil between the top and bottom blades.

⚠ If the blade is not adequately lubricated, it can cause heating and decrease the durability of the clipper, blades and may reduce the battery runtime

Lubricate the blades sufficiently during the clipping (at least every 15 minutes) or battery drainage can occur.

*Only use Joyzze special lubricant oil. See joyzze.com for details.

- The product comes with two types of adapters, the US standard and the universal standard. Customers outside of the United States might receive the universal standard adapter when purchasing. For universal standard adapter, please follow the installation steps below.

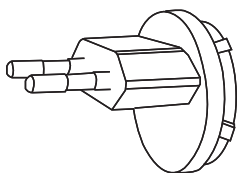

Generally Used in Continental Europe

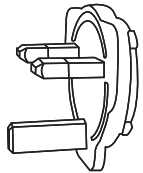

Generally Used in Great Britain

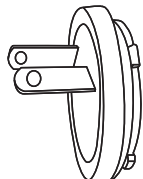

Generally Used in Australia

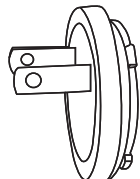

Generally Used in United States

Installation:

To attach the desired plug to the power adapter, align the slots on the plug to the ribs on the power adapter and turn the plug clockwise. The plug will “click” into position when is properly attached.

Removing:

While push the button on the power adaptor, turn the plug counterclockwise to remove it.

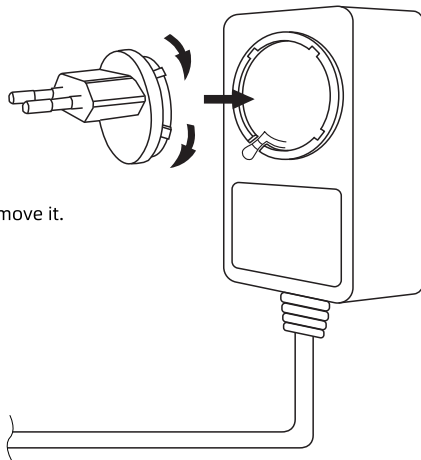
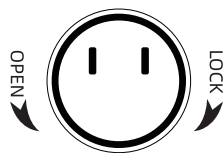
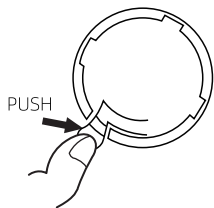

Note:

It is common that the battery pack and power adaptor to be warm when touching during charging or running, especially when the battery has been deeply discharged.

Register your product within 30 days of purchase to activate its 12-month warranty. Warranty is valid only when this card is completed and returned within 30 days of purchase. Online registration and mail registration are both available.

REGISTER ONLINE AT JOYZZE.COM

REGISTERED BY MAIL - PLEASE PREPARE:

1. Complete warranty card.
2. Proof of purchase. Cut out UPC from product package.
3. Copy of receipt.
Mail to Joyzze: P.O. Box 440098, Kennesaw, GA 30160

IF RETURNING FOR REPAIR SERVICE:

1. Submit the Required with Registration information if not already registered.
2. Pack clipper in bubble wrap to protect during shipping.
3. Enclose a return shipping fee of \$15.00 USD.

WARRANTY CARD

Salon / Customer's Name:		
Address:	Telephone:	
	E-mail:	
Date of Purchase (MM/DD/YY):	Serial Number:	
Store / Distributor's Name:	City:	State:

MALFUNCTION	CAUSE	RECTIFICATION
The blade is not functioning or is not moving as expected.	The blade is not properly secured or locked into place.	Make sure to properly align and securely attach the blade to the clipper body while the motor is running.
	The blade drive is not functioning correctly and may be damaged or overly wear.	The blade drive needs to be replaced by a trained technician or authorized service center.
	The shear and comb blades stick to each other, or the blade have not been lubricated with oil.	Carefully clean the blade and put a few drops of lubricant oil on the blade according to the suggestions.
The clipper cuts badly or not at all	The blades of the clipper are dull.	It is necessary to buy some new blades, or sharpened your old blades by a trained technician or authorized service center.
	Hair has become stuck or caught between the shear and comb blades.	Take off blade, push the shear blade half away from the blade, take away hair between shear and comb blades.
	The hair of the animal is damp or moist with water or another liquid.	To avoid damage to the clipper and ensure effective clipping, it is recommended to only use the clipper on dry coat.
	The tension spring on the blade pressure becomes less, can't applying enough pressure to effectively cut through the hair or fur.	It is necessary to buy some new tension springs and replace it.
The noise of the clipper becomes larger when in use even if a new blade is replaced.	The Blade Drive Assembly Lever is overly worn, or the Blade Hinge Assembly is deformed or worn.	Replace a new Blade Drive Assembly Lever or a set of Blade Hinge Assembly.
Running time of a fully charged battery is too short and / or blades are getting hot.	The shear and comb blades stick to each other, or the blade have not been lubricated with oil.	Carefully clean the blade and put a few drops of lubricant oil on the blade according to the suggestions.
	The pressure of the tension spring on the blades of other brands used is very high, which causes the blades to heat quickly and consume battery power more quickly.	Only use Joyzze brand blades in good condition.

MALFUNCTION	CAUSE	RECTIFICATION
Speed adjustment of the clipper is not working.	Motor or Circuit board failure.	Contact Joyzze service center or local distributor.
The motor is not functioning or is not starting up, even if a fully charged battery pack or the direct operation adaptor is well connected to the clipper handpiece.	The electrical contacts of the clipper is covered in hair, dust, or other debris, which may prevent them from making proper contact.	Turn off the clipper, clean both the contacts of the clipper and the battery pack or the direct operation adaptor with a clean cloth or brush, removing any dirt, dust, or debris that may be preventing proper electrical contact.
	There is a problem with the motor and/or electronics of the clipper, which is causing it to malfunction or not work properly.	Contact Joyzze service center or local distributor.
The battery charging indicator is not on, or when the clipper is full charged but the indicator does not change from red to green.	The blade is obstructed or clogged, preventing it from functioning properly.	To address the issue of a blocked or clogged blade, it is necessary to clean and oil the blade or change a new blade.
	Contacts of clipper and/ or charging station are dirty.	Unplug the adaptor from the charging station and gently remove hair or other debris with a soft brush or vacuum cleaner.
	Faulty battery or Circuit board failure.	Contact Joyzze service center or local distributor.
Poor contact with power adapter	Contacts of the charging station are deformed or the charging station is faulty.	Contact Joyzze service center or local distributor.
	The internal power line is broken after a long period of use.	Replace the power adapter.

Customer Service

For customer service please e-mail to info@JOYZZE.com or call toll free 877.456.9993 (U.S. and Canada)

For outside U.S. and Canada, please dial +1 877.456.9993

When the blades of your Joyzze clipper become dull after repeated use, it is advised to purchase a new set of blades available through your Joyzze supplier.

Some blade sets maybe resharpened - contact your Joyzze supplier or the Joyzze USA Inc. for information on resharpening.

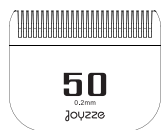

50
0.2mm - 1/125"
(Item: #0016)



40
0.25mm - 1/100"
(Item: #0023)

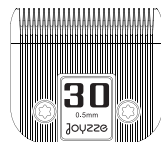

30
0.5mm - 1/50"
(Item: #0030)

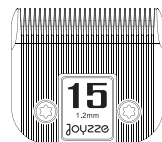

15
1.2mm - 3/64"
(Item: #0047)

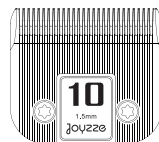

10
1.5mm - 1/16"
(Item: #0054)

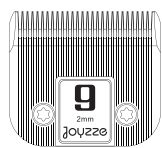

9
2mm - 5/64"
(Item: #0061)

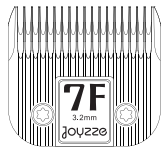

7F
3mm - 1/8"
(Item: #0078)

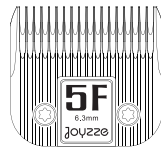

5F
6mm - 1/4"
(Item: #0085)

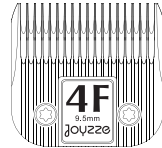

4F
9mm - 3/8"
(Item: #0092)

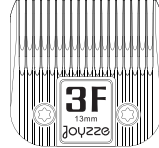

3F
13mm - 1/2"
(Item: #0108)

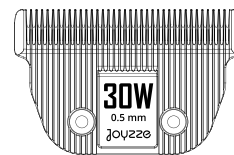

30W
0.5mm - 1/50"
(Item: #0467)

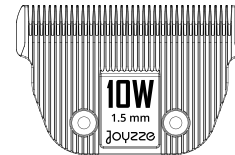

10W
1.5mm - 1/16"
(Item: #0474)

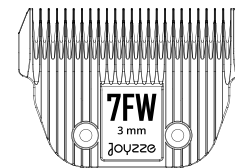

7FW
3mm - 1/8"
(Item: #0481)

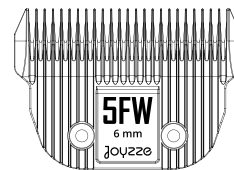

5FW
6mm - 1/4"
(Item: #0498)

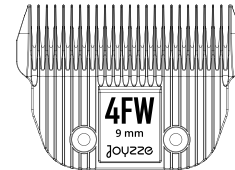

4FW
9mm - 3/8"
(Item: #0511)

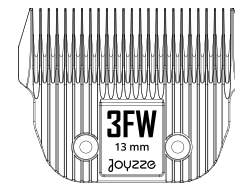

3FW
13mm - 1/2"
(Item: #0504)

A SERIES BLADE

FITS JOYZZE A-SERIES & MOST SNAP-ON A5 STYLE CLIPPERS

Joyzze A Series blades are engineered and calibrated for precision cutting. State of the art manufacturing technologies and processes are utilized to ensure optimal performance and durability. A special proprietary coating is applied to ensure these blades will run cooler and get through any heavy duty job with ease.

AW SERIES WIDE BLADE

FITS JOYZZE A-SERIES & MOST SNAP-ON A5 STYLE CLIPPERS

Joyzze wide blades are designed to save you time. These blades are 35% wider than any standard A series blade. State of the art manufacturing technologies and processes are utilized to ensure optimal performance and durability. A special proprietary coating is applied to further ensure that these blades will run cooler and get through any heavy-duty job with ease. Suitable for all breed sizes.

8 PIECE STAINLESS STEEL COMB SET (ITEM #: 0207)

8 sizes stainless steel metal comb set specially designed for JZA models / Raptor & Falcon, or other A5 clippers for additional cutting lengths.

for more product information please visit JOYZZE.com.

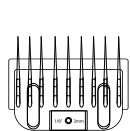

1/8" - 3mm

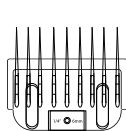

1/4" - 6mm

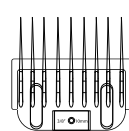

3/8" - 10mm

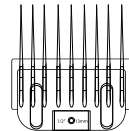

1/2" - 13mm

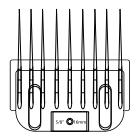

5/8" - 16mm

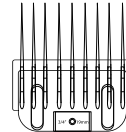

3/4" - 19mm

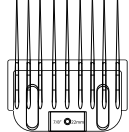

7/8" - 22mm

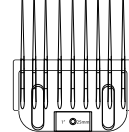

1" - 25mm



*use comb attachments with #10, #15, or #30 blades only.

FOR BEST RESULTS USE ON UNTANGLED BRUSHED HAIR.

8 PIECE STAINLESS STEEL WIDE COMB SET

8 sizes stainless steel metal comb set specially designed for [JOYZZE AW SERIES WIDE BLADES](#).

for more product information please visit JOYZZE.com.

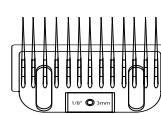
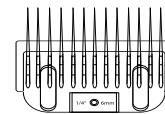
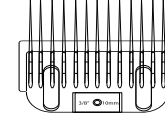
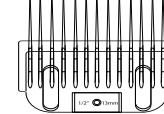
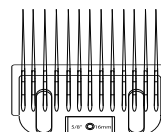
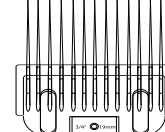
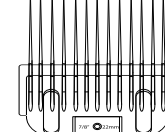
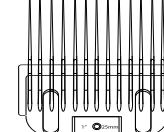
1/8" - 3mm
(Item: #0535)1/4" - 6mm
(Item: #0542)3/8" - 10mm
(Item: #0559)1/2" - 13mm
(Item: #0566)5/8" - 16mm
(Item: #0573)3/4" - 19mm
(Item: #0580)7/8" - 22mm
(Item: #0597)1" - 25mm
(Item: #0603)

FOR BEST RESULTS USE ON UNTANGLED BRUSHED HAIR.