

## MANUFACTURER'S 12 MONTH LIMITED WARRANTY

Your Joyzze clipper is warranted against manufacturer's defects for one year from the date of purchase. If your Joyzze clipper is determined to be defective in material or workmanship during the warranty period, Joyzze will repair or replace the product. Customer only pays shipping. Return the defective product along with proof of purchase, enclose a return fee of \$15.00 USD, and a note explaining the problem to:

Joyzze Service, P.O. Box 440098, Kennesaw, GA 30160.

Modifications or repairs not made by Joyzze™: accidental damage, misuse, neglect, use of unauthorized attachments or parts are not covered by this warranty.

For customer service please e-mail [info@JOYZZE.com](mailto:info@JOYZZE.com) or call toll free 877.456.9993 (U.S. and Canada)  
For outside U.S. and Canada, please dial +1 877.456.9993

**JOYZZE**  
JOY OF GROOMING MADE EASY™

JOYZZE USA, INC.

- 📍 P.O. Box 440098 Kennesaw, GA 30160 USA
- ☎ 877.456.9993 ( 877.4JO.YZZE )
- 🌐 JOYZZE.com

Ver 1.0 EN

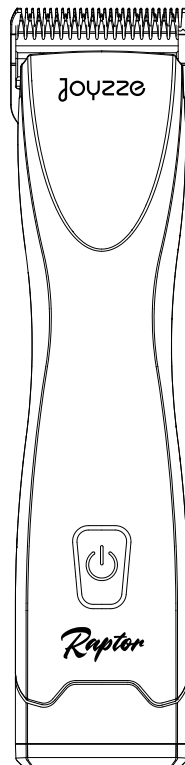

**JOYZZE**  
JOY OF GROOMING MADE EASY™

# Raptor Clipper

## USER MANUAL

*Model: JZA-1*

- Item: #0641 Raptor Cordless Plus (2 Batteries)
- Item: #0658 Raptor Cordless (1 Battery)
- Item: #0665 Raptor Corded

**NOTE:**

It is essential to follow basic safety precautions, including thoroughly reading and understanding all provided instructions, before operating your Joyzze clipper.

**SAFETY:**

Failure to comply with the safety instructions and regulations outlined in this manual could lead to equipment malfunctions or cause serious personal harm.

**HAZARD SYMBOLS**

*To prevent a potential hazard, it is essential to take appropriate precautions.  
Failure to do so can result in serious injury, and in some cases, even death.*

**1.1 Symbols and Warning Notes**

The operating instructions contain various symbols indicating possible hazards or technical information that, if not followed, may result in personal injury, material damage, or uneconomical operation.

**1.2 Personal**

Only individuals experienced in handling the animals to be clipped should operate the clipper.

Children are NOT permitted to operate the equipment.

Individuals who may be under the influence of drugs, alcohol, or medication should not use the equipment.

**1.3 Intended Usage**

The equipment is intended for the specific use described in this manual.

The equipment is intended for use only on dogs, cats, cattle, and horses.

Compliance with all instructions in this manual is part of the intended use.

Any other use of the equipment is expressly prohibited.

**DO NOT use the clipper:**

- **On humans**
- **To clip other animals** (*other than dogs, cats, cattle, and horses*)

**1.4 Personal Protective Equipment**

Anti-slip shoes are required to protect against slipping on slippery surfaces.

**1.5 Power Supply** **The device must only be operated with the provided power supply unit.**

To reduce the risk of electric shock:

Do not touch the device if it falls into water. Immediately unplug it from the socket.

Do not use while bathing or showering.

Do not place or store the appliance where it may fall or be pulled into a tub or sink. Do not place it in or drop it into water or other liquids.

Always unplug the appliance from the electrical outlet immediately after use, except when charging.

Unplug the appliance before cleaning.

To reduce the risk of burns, fire, electric shock, or injury to persons:

Never leave the appliance unattended when it is plugged in.

Do not use attachments not specified by the manufacturer.

Never use the device if the cable or outlet is damaged or if it does not work properly after falling, sustaining damage or landing in water.

Keep the cord away from heated surfaces.

Keep the air openings free of lint, hair, and similar objects.

Never drop or insert any object into any opening.

Do not use outdoors or operate while aerosol (spray) products are being used.

Do not use this appliance with a damaged or broken comb, as it has the potential to result in injury.

First, insert the plug into the device before plugging it into the outlet. To disconnect, turn all controls to the off position and then remove the plug from the outlet.



Never leave the equipment unsupervised and use it very carefully when children or individuals who cannot assess the dangers are nearby.

Children are not permitted to operate the equipment.

Children should be supervised to ensure that they do not play with the equipment.

**⚠ WARNING! KEEP THE DEVICE DRY.****1.6 Battery Pack and Charging Station** ⚠ The device must ONLY be operated with a Joyzze Battery Pack and Charging Station

The clipper's battery pack may vent or rupture if crushed, heated, incinerated, short-circuited, or immersed in any liquid.

Do not insert metallic objects into the battery cavities of the charging station.

To clean external parts of the charging station, use a soft brush or damp cloth. Do not use harsh abrasives, detergents, or solvents.

Do not use this lithium-ion battery to power any product other than the Joyzze Raptor clipper.

The battery contains an overload protection feature. In extreme cases, overload protection may cause the battery to become inoperable.

For maximum battery life, do not store clipper, charging station or battery pack under 50°F or over 104°F.

Do not expose the clipper, charging station or battery pack to excessively damp conditions.

Take care not to drop the clipper, charging station or battery pack. Do not attempt to use a damaged charging station or battery pack.

**1.7 Animals** ⚠

The appliance is intended for trimming purposes only.

The noise of the clipper can disturb animals.

The animal should be fixed and calmed sufficiently before clipping.

Do not charge, install or leave the device in places where it may be exposed to damage from an animal.

**1.8 Clipping Blades** ⚠

Moving blades and sharp edges of the blades can cause injuries to the skin.

Work carefully.

Avoid any contact with the moving blades.

**GENERAL**

This manual is designed to help you handle the machine safely and efficiently. Before operating the equipment, carefully read and understand these instructions.

The safe operation of the equipment requires compliance with all safety and operating information in this manual.

Keep this manual at all times. If you hand over the equipment to other individuals, provide them with this manual.

**1.1 Guarantee Condition**

The guarantee conditions are included in the manufacturer's general terms and conditions.

**1.2 Customer Service**

For technical information, our customer service and authorized service centers are available to you.

In addition, our staff is interested in new information and experiences resulting from the operation, which could be useful for improving our products.

**1.3 Limitation of Liability**

The manufacturer assumes no liability for disadvantages due to:

Non-compliance with the instruction manual.

Operation of the clipper for unintended use.

Use of unauthorized personnel.

Technical modifications.

Use of unauthorized spare parts.

The actual scope of delivery may differ from specially designed models, additional ordering options, or due to the latest state of the art from the annotations and illustrations described here.

This product has been developed and assembled using the best individual components available. It is designed to provide longevity and high performance.

If spare parts are used during the life of this product, please ensure that they are genuine Joyzze parts. Failure to use genuine Joyzze spares may reduce the performance of this precision-engineered product and will void any warranty claim.

### FAILURE TO CHARGE

Make sure the outlet is working and plugs are well seated in the clipper and outlet. If clipper still fails to charge return for maintenance (see Manufacturer's 12 Month Limited Warranty).

### LITHIUM-ION BATTERY USE, STORAGE, AND DISPOSAL

1. The Joyzze Raptor Cordless Clipper comes with a rechargeable lithium-ion battery pack. The battery does not develop a "memory effect". You can return the battery pack to the charger at any time for a full charge, or even use the battery before a charge cycle is complete. Like most rechargeable batteries, lithium-ion batteries perform best when used frequently.
2. For maximum battery life, if the battery pack will be in storage from several months or longer, store with a partial battery charge of about 40%.
3. Store battery pack in temperatures between 50°F/10°C and 104°F/40°C. Do not store in damp conditions.
4. Do not place the clipper and the battery pack near heat vents, radiators, or in direct sunlight. Optimal charging requires stable temperature conditions while sudden increases in temperature will reduce battery charge capacity.
5. Initially, new lithium-ion batteries, unused for a period of time, may not accept a full charge. This is normal and does not indicate a problem with the battery or charger. The battery will accept a full charge after several cycles of clipper use and recharging.
6. When not in use for extended periods, disconnect the adapter cord from the AC outlet.
7. Many factors influence lithium-ion battery life. A battery that has received heavy use or is more than a year old may not give the same run-time performance as a new battery pack.
8. Check with your municipal solid waste organizations for details on lawful disposal and recycling options.

### CLIPPER REPAIR SERVICE

Please call Joyzze Customer Service at 877.456.9993 or email us at [info@joyzze.com](mailto:info@joyzze.com) for assistance resolving any issues you're experiencing with your Joyzze Clipper. If your issues cannot be resolved over the phone or via email we will assist you with the return for repair service process. If you wish your clipper to be serviced as well it should be carefully packed, mailed and insured ONLY via United States Postal Service:

**JOYZZE**  
**P.O. Box 440098**  
**Kennesaw, GA 30160**

See Manufacturer's 12 Month Limited Warranty, Warranty Card, and Repair Service Instructions.

**J**

## Clipper Body (with #10 A5 style blade\*1)

Model	JZA-1
Input	9V = 3A
Power	27W Max
Speed (3-Speed)	2500 - 3100 - 3800 SPM
Noise	≤ 70 dB

## Power Adaptor (Input: 100-240V ~ 50/60Hz)

USA Adaptor	(Item: #0931)
Universal	(Item: #0924)

\* Different adapter & plugs in the packaging for different countries and regions.

## Package Includes

Item	Raptor Corded	Raptor Cordless	Raptor Cordless Plus
Clipper Body	●	●	●
Power Adaptor	●	●	●
Lubricant Oil	●	●	●
Cleaning Brush	●	●	●
Manual	●	●	●
Non-Slip Sleeve	●	●	●
Direct Operation Adaptor	●	/	/
Charging Station	/	●	●
Battery Pack	/	*1	*2

With the purchase of a charging station and battery pack, the corded version of the clipper can be upgraded to a cordless version.

## Battery Pack (Item: #0672)

Li-ion Battery	7.4V 3500mAh
Charging Time	120 minutes
Running Time	220-300 minutes (Depending on the speed)

## Charging Station (Item: #0689)

Input	9V = 3A
Wall Hanging Hole	*2

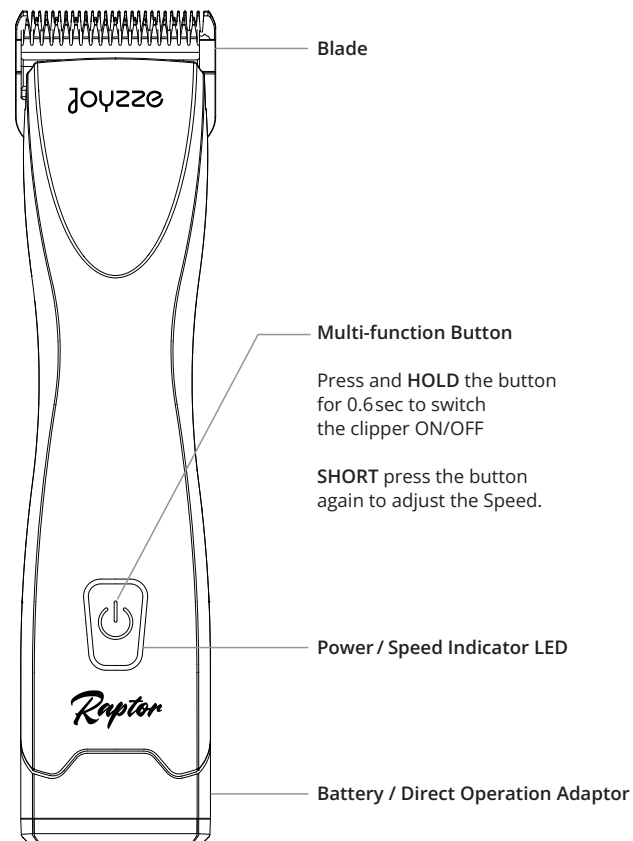

# Raptor

## Accessories:



\* Different adapter & plugs in the packaging for different countries and regions.

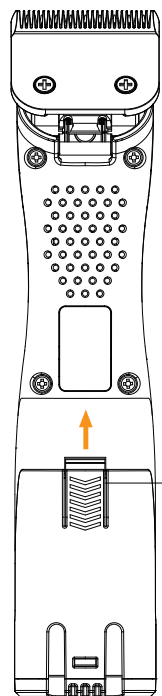

①

Release Button

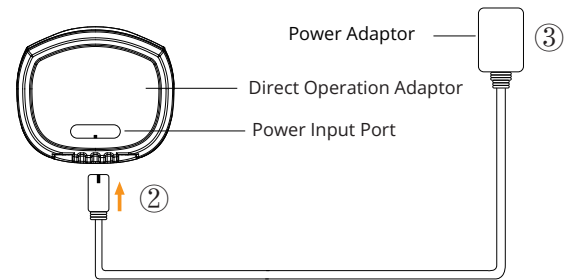

Power Adaptor ③

Direct Operation Adaptor

Power Input Port

## RAPTOR CORDED

- ① Slide the Direct Operation Adaptor into the Clipper Body.
- ② Insert the power adaptor output plug to the Direct Operation Adaptor.
- ③ Connect the power adaptor to the wall outlet.
- ④ Press and hold the Multi-function button for 0.6sec to switch the clipper ON.

## RAPTOR CORDLESS

Slide the charged battery pack into the clipper body.  
Press and hold the Multi-function button for 0.6sec to switch the clipper ON.

\* The battery pack and the direct operation adaptor are removable from the clipper.  
press the release button and push them slide out.

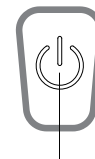
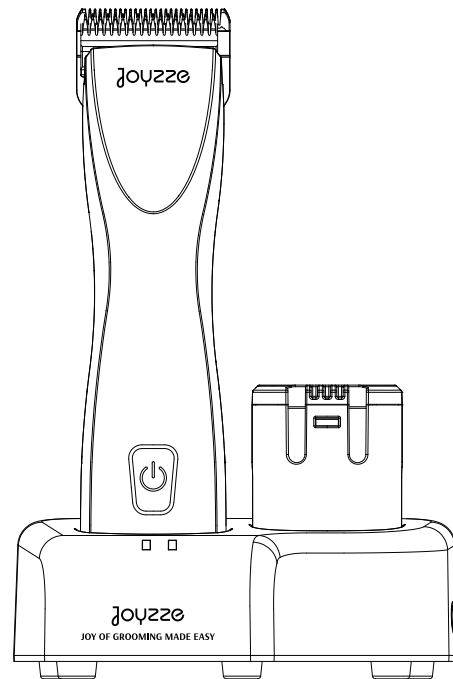

### Multi-function Button

- ① Press and hold the button for 0.6 sec to switch the clipper ON/OFF.  
After the clipper is powered on, the default speed is 3100 SPM.
- ② Short press to switching the speed: 3100 - 3800 - 2500,  
which can be cyclic switching.

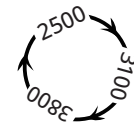

Short press the power button again to adjust the speed.

\*When the battery level is lower than 25%, the high speed (3800SPM) will be reduced to avoid over exhaustion of the battery.

### Power / Speed Indicator LED

High speed rolling light: 3800 SPM  
Always on: 3100 SPM  
Low speed rolling light: 2500 SPM

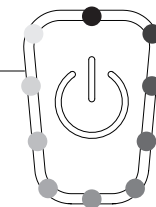

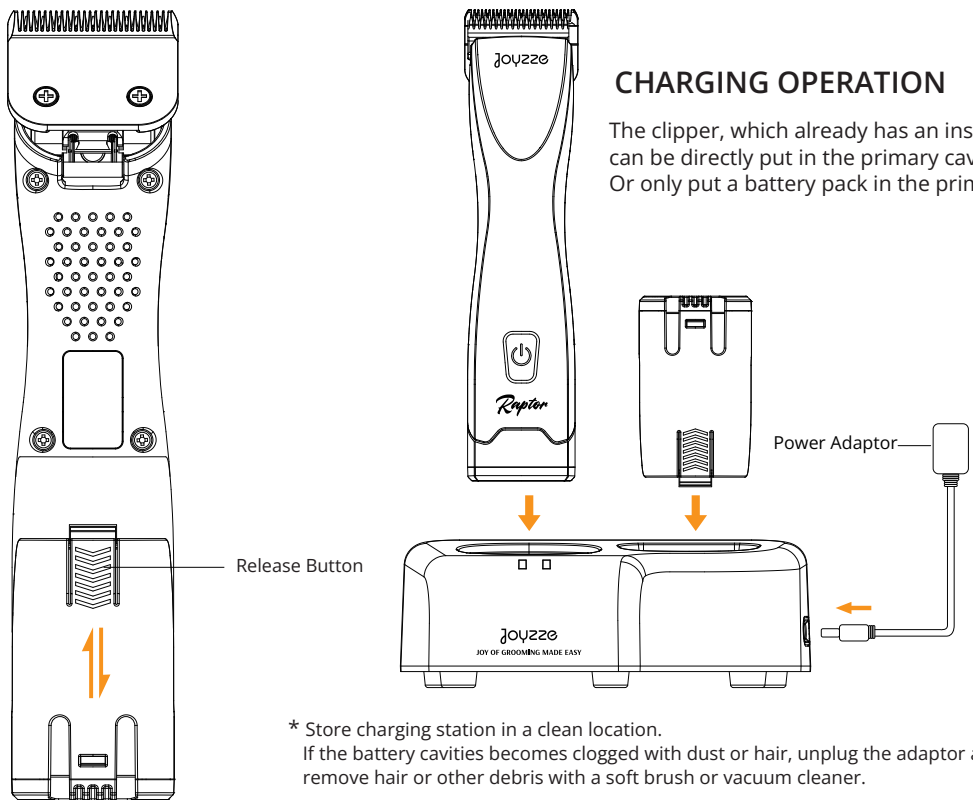

### CHARGING OPERATION

The clipper, which already has an installed battery pack, can be directly put in the primary cavity for charging. Or only put a battery pack in the primary cavity for charging.

Release Button

\* Store charging station in a clean location.  
If the battery cavities becomes clogged with dust or hair, unplug the adaptor and gently remove hair or other debris with a soft brush or vacuum cleaner.

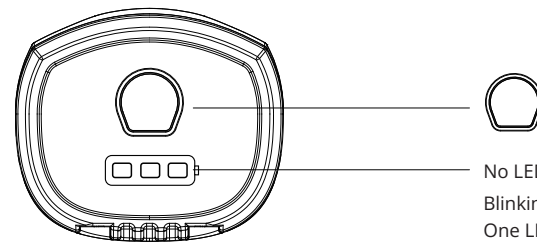

### BATTERY POWER INDICATE

On the bottom of the power adaptor, hold down the button to view the battery charge level.

- No LED light up: Exhausted or faulty battery - Try recharge.
- Blinking one LED: Battery level ca. 0-10% – Recharge immediately.
- One LED lights up: Battery level ca. 11-35%
- Two LEDs light up: Battery level ca. 36-66%
- Three LEDs light up: Battery level ca. > 66%
- \* LEDs will be off automatically after 5 seconds after release the button.

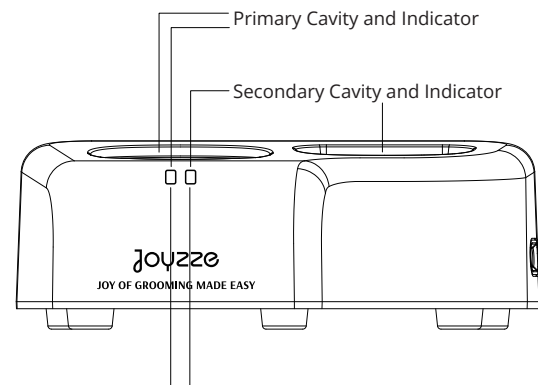

### CHARGING OPERATION

There are two cavities in the charging station, which can intelligently charge the two battery packs.\*

- ① When the two battery packs are placed in the two cavities at a same time, the battery pack in the primary cavity will be charged first.
- ② When the battery pack in the primary cavity is fully charged, or removed from of the primary cavity, it will continue to charge the spare battery pack in the secondary cavity.

### BATTERY CHARGING INDICATOR

The red light is always on when the battery is charging, and the green light is always on after the battery is fully charged.

\*Batteries will not simultaneously charge

◆ **BLADE INSTALLATION**

Insert the blade slot into the blade latch, and fold it on to the switched-on clipper by light pressure, press the blade down and hear a "click".

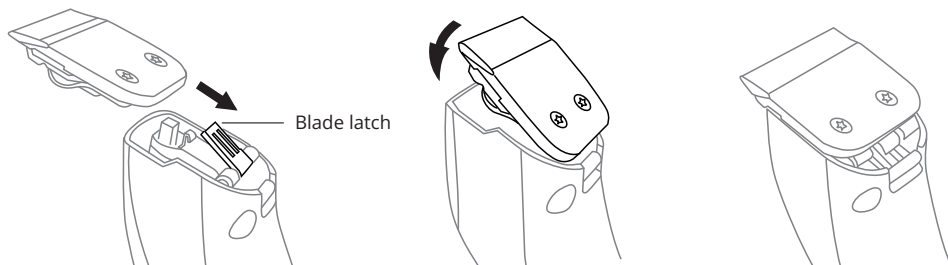
◆ **BLADE REMOVAL**

Push the release button to the end, at the same time, fold the blade backward, pull the blade out of the latch with another hand to take off the blade.

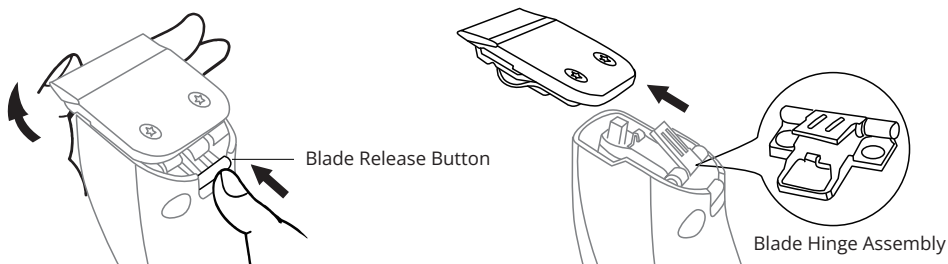

**CAUTION:** Turn OFF the clipper and disconnect from outlet before performing maintenance.

◆ **BLADE REMOVAL** ⚠

If the blade latch is accidentally closed, please use a flat screwdriver, insert into the latch gap and pry it up as figure suggests.

CAUTION is advised to not damage any components while conducting the suggested method above.

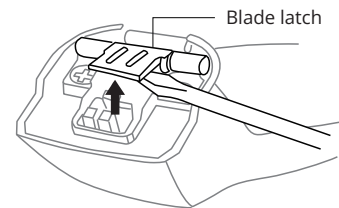
◆ **BLADE MAINTENANCE**

1. **Blade cleaning:** Move the shear blade within a short range and use the brush to remove hair that is stuck between the shear blade and the comb blade.

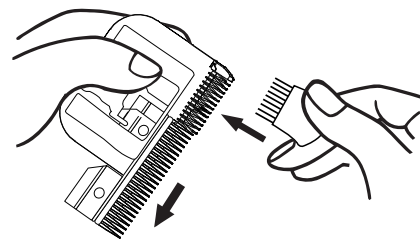

2. **Blade oiling:** The blades must be oiled before, during and after every use. When the blades of the clipper are leaving stripes, this is a signal that oil is required.

*Place 1-2 drops of lubricating oil ahead and laterally on the blade shown below. Wipe off the excessive oil with a smooth, dry cloth.*

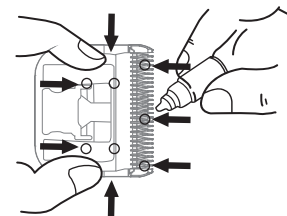

*In order to achieve optimal clipping performance and enhance the longevity of both the clipper and the blade, it is important to apply a thin coat of oil between the top and bottom blades.*



If the blade is not adequately lubricated, it can cause heating and decrease the durability of the clipper, blades and may reduce the battery runtime

Lubricate the blades sufficiently during the clipping (at least every 15 minutes) or battery drainage can occur.

\*Only use Joyzze special lubricant oil. See Joyzze.com for details.



- ◆ The universal power adaptor is equipped with interchangeable wall plugs that support universal AC voltage, making it suitable for use in most countries worldwide.

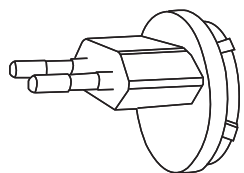

Generally used in Continental Europe

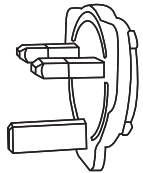

Generally used in Great Britain

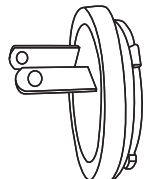

Generally used in Australia

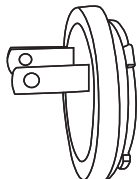

Generally used in United States

**Installation:**

To attach the desired plug to the power adapter, align the slots on the plug to the ribs on the power adapter. Turn clockwise into place. The plug will "click" into place when properly attached.

**Removing:**

Simultaneously push the button on the power adaptor and turn the plug counterclockwise to remove it.

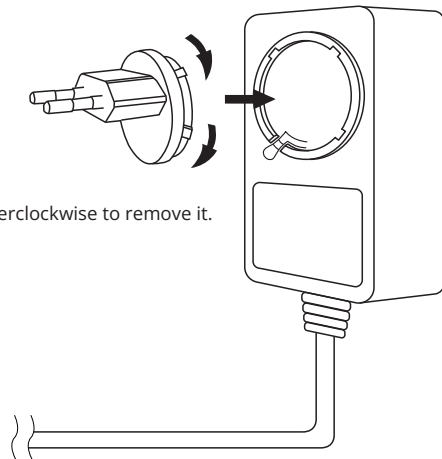
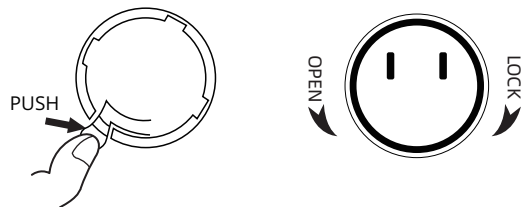

**Note:**

That it is normal for the battery pack and power adapter to feel warm to the touch when charging or running. This is especially true if the battery has been deeply discharged and/or while the clipper is running.

Register your clipper within 30 days of purchase to activate its 12-month warranty. Warranty is valid only when this card is completed and returned within 30 days of purchase. Online registration and mail registration are both available.

**REGISTER ONLINE: JOYZZE.COM**

**REGISTERED BY MAIL:**

PLEASE PREPARE:

1. Complete warranty card.
2. Proof of purchase. Cut out UPC from product package.
3. Copy of receipt.  
Mail to Joyzze: P.O. Box 440098, Kennesaw, GA 30160

**IF RETURNING FOR REPAIR SERVICE:**

1. Submit the Required with Registration information if not already registered.
2. Pack clipper in bubble wrap to protect during shipping.
3. Enclose a return shipping fee of \$15.00 USD.

WARRANTY CARD

Consumer's Name:		
Address:	Telephone:	
	E-mail:	
	Date of Purchase (MM/DD/YY):	Serial Number:
Store / Distributor's Name:	City:	State:

MALFUNCTION	CAUSE	RECTIFICATION
The blade is not functioning or is not moving as expected.	The blade is not properly secured or locked into place.	Make sure to properly align and securely attach the blade to the clipper body while the motor is running.
	The blade drive is not functioning correctly and may be damaged or overly wear.	The blade drive needs to be replaced by a trained Joyzze™ technician or authorized service center.
	The shear and comb blades stick to each other, or the blade has not been lubricated with oil.	Carefully clean the blade and put a few drops of lubricant oil on the blade according to the suggestions.
The clipper cuts badly or not at all	The blades of the clipper are dull.	It is necessary to buy some new blades, or sharpened your old blades by a trained Joyzze™ technician or authorized service center.
	Hair has become stuck or caught between the shear and comb blades.	Take off blade, push the shear blade half away from the blade, take away hair between shear and comb blades.
	The hair of the animal is damp or moist with water or another liquid.	To avoid damage to the clipper and ensure effective clipping, it is recommended to only use the clipper on dry coat.
	The tension spring on the blade pressure becomes less, can't apply enough pressure to effectively cut through the hair or fur.	It is necessary to buy some new tension springs and replace it.
The noise of the clipper becomes louder when in use even if a new blade is replaced.	The blade drive is overly worn, or the blade fixed components is deformed or worn.	Replace a new blade drive or a set of blade fixed components.
Running time of a fully charged battery is too short and / or blades are getting hot.	The shear and comb blades stick to each other	Oil the blade
	The pressure of the tension spring on the blades of other brands used is very high, which causes the blades to heat quickly and consume battery power more quickly.	Only use Joyzze brand blades in good condition.

MALFUNCTION	CAUSE	RECTIFICATION
Speed adjustment of the clipper is not working.	Motor or Circuit board failure.	Contact Joyzze™ service center or local distributor.
The motor is not functioning or is not starting up, even if a fully charged battery pack or the direct operation adaptor is well connected to the clipper body.	The electrical contacts of the clipper is covered in hair, dust, or other debris, which may prevent them from making proper contact.	Turn off the clipper, clean both the contacts of the clipper and the battery pack or the direct operation adaptor with a clean cloth or brush, removing any dirt, dust, or debris that may be preventing proper electrical contact.
	There is a problem with the motor and/or electronics of the clipper, which is causing it to malfunction or not work properly.	Contact Joyzze™ service center or local distributor.
The battery charging indicator of the charging station is not on, or when the battery pack is full charged the indicator does not change from red to green.	The blade is obstructed or clogged, preventing it from functioning properly.	To address the issue of a blocked or clogged blade, it is necessary to clean and oil the blade or change a new blade.
	Contacts of battery pack and/ or charging station are dirty.	Unplug the adaptor and gently remove hair or other debris with a soft brush or vacuum cleaner.
	Faulty battery pack	Replace battery pack
Poor contact with power adapter	Contacts of the charging station are deformed or the charging station is faulty.	Contact Joyzze™ service center or local distributor.
	The internal power line is broken after a long period of use.	Replace the power adapter.

### Customer Service

For customer service please e-mail to [info@JOYZZE.com](mailto:info@JOYZZE.com) or call toll free 877.456.9993 (U.S. and Canada)

For outside U.S. and Canada, please dial +1 877.456.9993

If the blades of your Joyzze clipper become dull due to frequent use, it is recommended to purchase a new set of blades from your Joyzze supplier. Some blade sets may be eligible for sharpening. For more information on sharpening, you can contact your Joyzze supplier or Joyzze at [info@joyzze.com](mailto:info@joyzze.com).

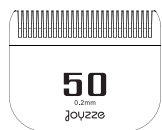
**50**

0.2mm

JOYZZE

**50**

0.2mm - 1/125"

(Item: #0016)

**40**

0.25mm

JOYZZE

**40**

0.25mm - 1/100"

(Item: #0023)

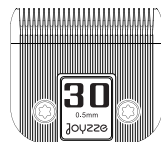
**30**

0.5mm

JOYZZE

**30**

0.5mm - 1/50"

(Item: #0030)

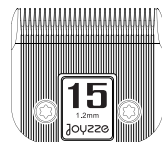
**15**

1.2mm

JOYZZE

**15**

1.2mm - 3/64"

(Item: #0047)

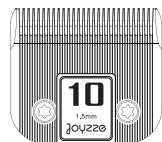
**10**

1.5mm

JOYZZE

**10**

1.5mm - 1/16"

(Item: #0054)

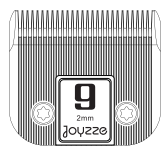
**9**

2mm

JOYZZE

**9**

2mm - 5/64"

(Item: #0061)

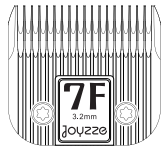
**7F**

3mm

JOYZZE

**7F**

3mm - 1/8"

(Item: #0078)

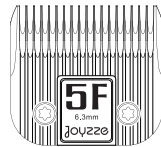
**5F**

6.3mm

JOYZZE

**5F**

6mm - 1/4"

(Item: #0085)

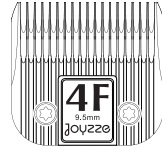
**4F**

9mm

JOYZZE

**4F**

9mm - 3/8"

(Item: #0092)

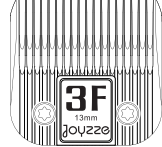
**3F**

13mm

JOYZZE

**3F**

13mm - 1/2"

(Item: #0108)

### **A SERIES BLADE**

**FITS JOYZZE A-SERIES & MOST SNAP-ON A5 STYLE CLIPPERS**

Joyzze A Series blades are engineered and calibrated for precision cutting. State of the art manufacturing technologies and processes are utilized to ensure optimal performance and durability. A special proprietary coating is applied to ensure these blades will run cooler and get through any heavy duty job with ease.

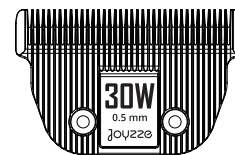
**30W**

0.5mm - 1/50"

(Item: #0467)

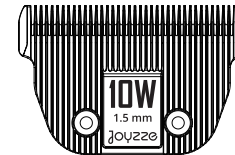
**10W**

1.5mm - 1/16"

(Item: #0474)

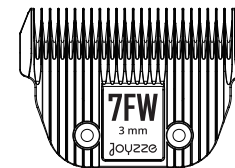
**7FW**

3mm - 1/8"

(Item: #0481)

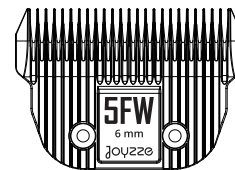
**5FW**

6mm - 1/4"

(Item: #0498)

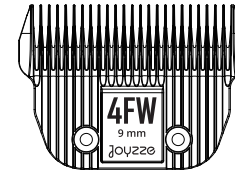
**4FW**

9mm - 3/8"

(Item: #0511)

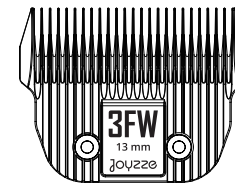
**3FW**

13mm - 1/2"

(Item: #0504)

### **AW SERIES WIDE BLADE**

**FITS JOYZZE A-SERIES & MOST SNAP-ON A5 STYLE CLIPPERS**

Joyzze wide blades are designed to save you time. These blades are 35% wider than any standard A series blade. State of the art manufacturing technologies and processes are utilized to ensure optimal performance and durability. A special proprietary coating is applied to further ensure that these blades will run cooler and get through any heavy-duty job with ease. Suitable for all breed sizes.

**8 PIECE STAINLESS STEEL COMB SET (ITEM #: 0207)**

8 sizes stainless steel metal comb set specially designed for JZD models / Piranha, JZA models / Raptor & Falcon, or other A5 clippers for additional cutting lengths.

For more product information please visit [JOYZZE.com](http://JOYZZE.com).

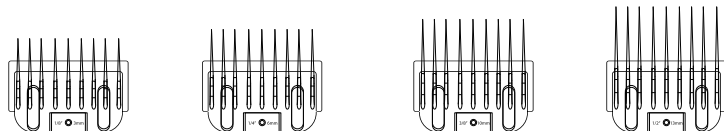

1/8" - 3mm

1/4" - 6mm

3/8" - 10mm

1/2" - 13mm

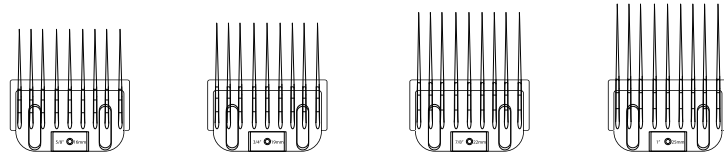

5/8" - 16mm

3/4" - 19mm

7/8" - 22mm

1" - 25mm



**\*USE COMBS WITH #10, #15, OR #30 BLADES ONLY**

FOR BEST RESULTS USE ON UNTANGLED, BRUSHED HAIR.

**8 PIECE STAINLESS STEEL WIDE INDIVIDUAL COMBS**

8 sizes stainless steel metal comb set specially designed for **JOYZZE AW SERIES WIDE BLADES**.

For more product information please visit [JOYZZE.com](http://JOYZZE.com).

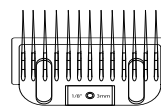
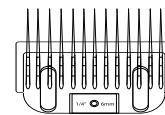
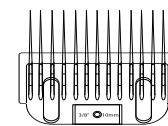
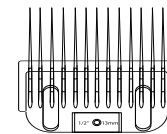
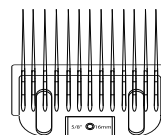
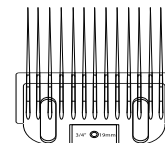
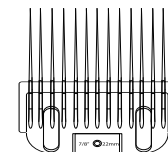
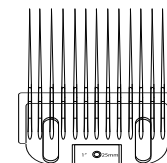
1/8" - 3mm  
(Item: #0535)1/4" - 6mm  
(Item: #0542)3/8" - 10mm  
(Item: #0559)1/2" - 13mm  
(Item: #0566)5/8" - 16mm  
(Item: #0573)3/4" - 19mm  
(Item: #0580)7/8" - 22mm  
(Item: #0597)1" - 25mm  
(Item: #0603)

**\*USE COMBS WITH #10, #15, OR #30 BLADES ONLY**

FOR BEST RESULTS USE ON UNTANGLED, BRUSHED HAIR.