

MANUFACTURER'S 12 MONTH LIMITED WARRANTY

Your Joyzze product is warranted against manufacturer's defects for one year from the date of purchase. If your Joyzze clipper is determined to be defective in material or workmanship during the warranty period, Joyzze will repair or replace the product. Customer only pays shipping. Return the defective product along with proof of purchase, enclose a return fee of \$15.00 USD, and a note explaining the problem to:

Joyzze Service, P.O. Box 440098, Kennesaw, GA 30160.

Modifications or repairs not made by Joyzze™: accidental damage, misuse, neglect, use of unauthorized attachments or parts are not covered by this warranty.

For customer service email info@Joyzze.com or call toll free 877.456.9993

JOYZZE

CLIPPERS & BLADES REIMAGINED™

JOYZZE USA, INC.

 P.O. Box 440098 Kennesaw, GA 30160 USA

 877.456.9993

 JOYZZE.com



JOYZZE

Hornet Cordless Clipper User Manual

Model: JZC-1



For manual in other languages visit Joyzze.com

Model	Hornet
Input	5V = 1A 5W
Lithium Battery	3.7V 2000mAh
Charge Time	80 minutes
Run Time	240 minutes
Speed (2-Speed)	5000 - 6000 SPM
Noise	≤ 60 dB
Package Includes	Clipper Magnetic horizontal charging station Attachment combs: 3mm / 6mm / 10mm Non-Slip grip sleeve USB Type-C cable (240cm/7.87ft) Brush Lubricant oil (8ml/0.27oz) Manual

Accessories:

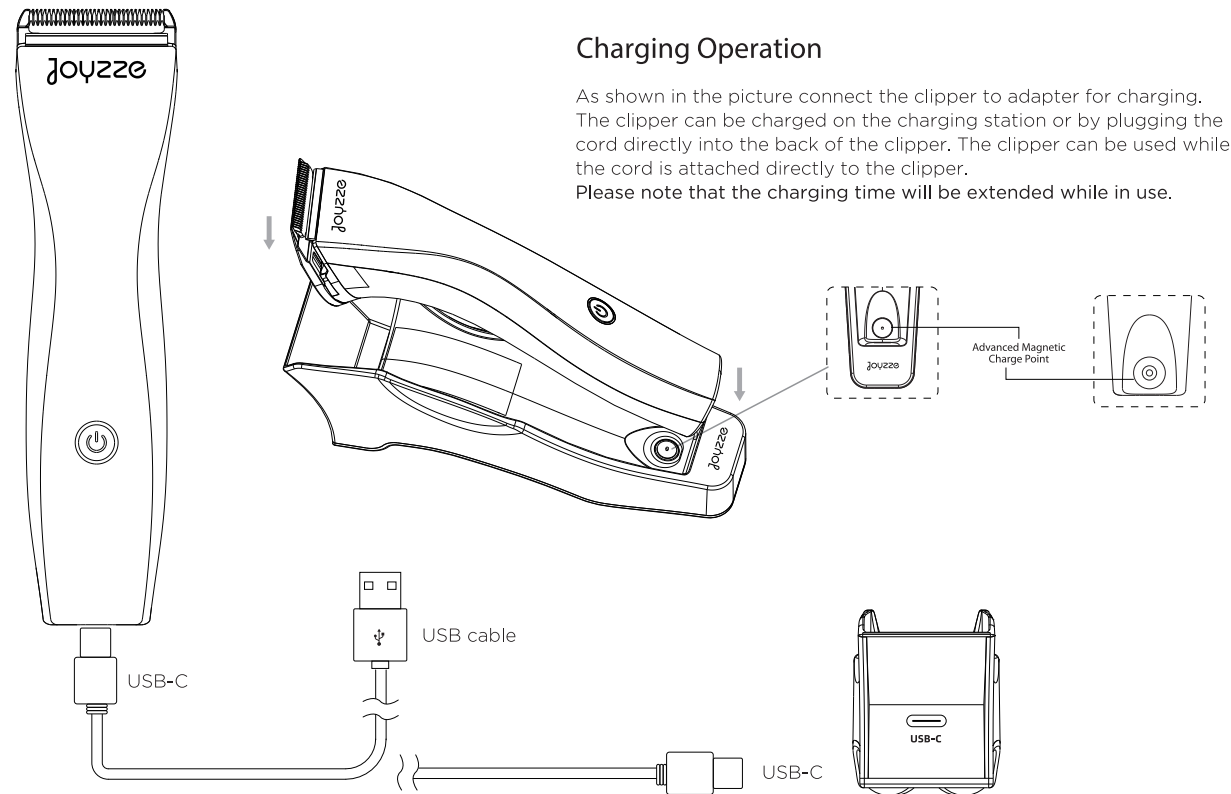
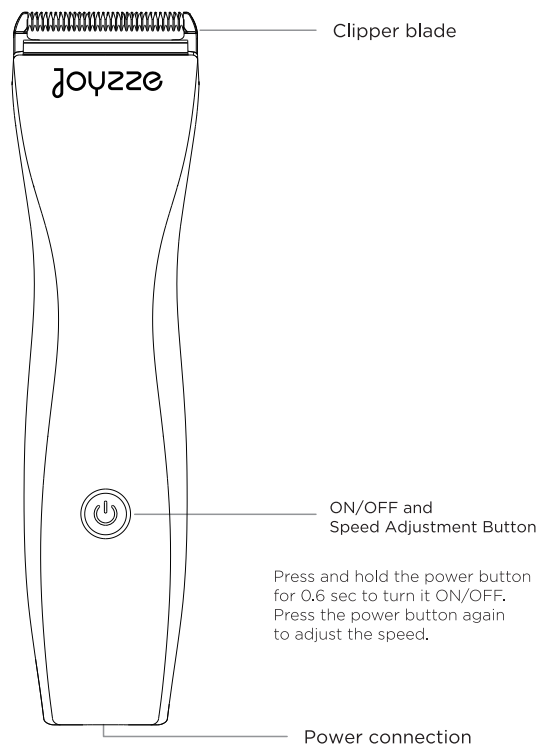
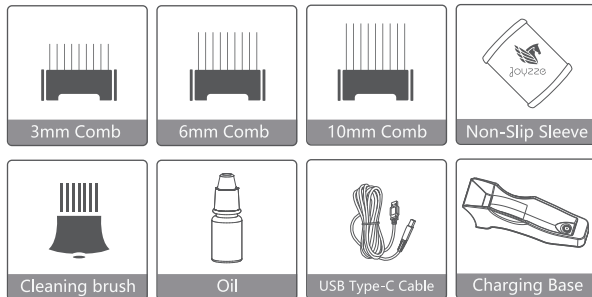

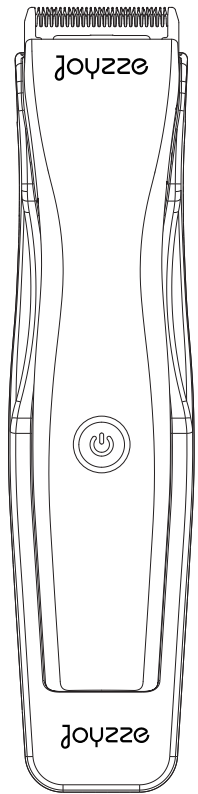

Charging State Display

-  Power 100%-30%: The upper part of button light flashes on white

-  Power 30%-10%: The upper part of button light flashes on red

-  Power ≤10%: The upper part of button light is always on red

Cordless Power Display

Low Speed Mode

-  Power 100%-30%: The button light flashes on white

-  Power 30%-10%: The button light flashes on red

-  Power ≤10%: Motor does not move, the button light flashes on red for 5 times

High Speed Mode

-  Power 100%-30%: The button light permanently on white (Means high power)

-  Power 30%-10%: The button light permanently on red (Means low power)

-  Power ≤10%: Motor does not move, the button light flashes on red for 5 times; (automatic shutdown)

Corded Power Display

Low Speed Mode

-  Power 100%-30%: The lower part of button light flashes on white
The upper part of button light flashes on white (Means high power)

-  Power 30%-10%: The lower part of button light flashes on red
The upper part of button light flashes on red (Means low power)

-  Power ≤10%: The button light flashes on red, motor does not move

High Speed Mode

-  Power 100%-30%: The lower part of button light permanently on white,
the upper part of button light flashes on white (Means high power)

-  Power 30%-10%: The lower part of button light permanently on red,
the upper part of button light flashes on red (Means low power)

-  Power ≤10%: The button light flashes on red, motor does not move

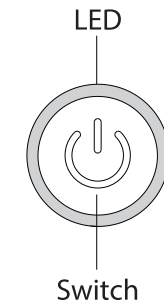

Press and hold the power button for 0.6 sec to turn it ON/OFF. Press the power button again to adjust the speed.

FAILURE TO CHARGE

Make sure the outlet is working and plugs are well seated in the clipper and outlet. If clipper still fails to charge return for maintenance (see Manufacturer's 12 Month Limited Warranty).

LITHIUM-ION BATTERY USE, STORAGE, AND DISPOSAL

1. The Joyzze Clipper comes installed with a rechargeable lithium-ion battery. The battery does not develop a memory effect and can be recharged at any time.
2. If the clipper will be in storage from several months or longer, store with a partial battery charge of about 40%.
3. Store clipper in temperatures between 50°F/10°C and 104°F/40°C. Do not store in damp conditions.
4. Do not place the clipper near heat vents, radiators, or in direct sunlight. Optimal charging requires stable temperature conditions while sudden increases in temperature will reduce battery charge capacity.
5. Initially, new lithium-ion batteries may not fully charge, but will after several recharge cycles.
6. When not in use for extended periods, disconnect the adapter cord from the AC outlet.
7. Check with your municipal solid waste organizations for details on lawful disposal and recycling options.

CLIPPER REPAIR SERVICE

Call Joyzze Customer Service at 877-456-9993 or email us at info@Joyzze.com for assistance resolving any issues you're experiencing with your Joyzze Clipper. If your issues cannot be resolved over the phone or via email we will assist you with the return for repair service process. If you wish your clipper to be serviced as well it should be carefully packed and mailed either Parcel Post Insured or U.P.S. to:

Joyzze P.O. Box 440098, Kennesaw, GA 30160.

See Manufacturer's 12 Month Limited Warranty, Warranty Card, and Repair Service Instructions.



CAUTION: Turn OFF the clipper and disconnect from outlet before performing maintenance.

Blade Removal, Maintenance and Installation

◆ Blade Removal

Hold the clipper face up with one hand and press the blade down with thumb.
Remove the blade into the other hand to avoid dropping the blade.

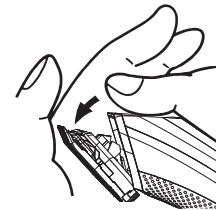

◆ Blade Maintenance

1. Blade cleaning: Press and hold the top of the shear blade. Use the cleaning brush to clean hair between the shear blade and the fixed blade.

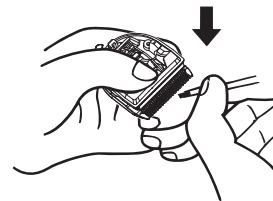

2. Blade oiling: Use 1-2 drops of lubricating oil on the 5 points shown below.

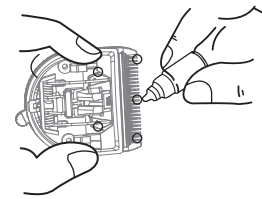

⊘ Do not detach the blade spring while maintaining to avoid malfunction.

◆ Blade Installation

Hold the clipper face down with one hand and place the bottom of the blade aligning the middle of the blade with the clipper. Push the front of the blade down until it snaps into place.

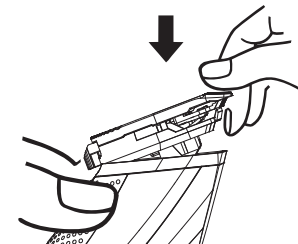

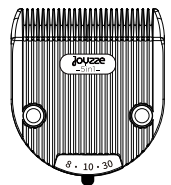

Standard-Adjustable Blade

Standard blade: 0.7 - 1.3 - 1.9 - 2.5 - 3.0 mm
 Size adjustable: 30 - 15 - 10 - 9 - 8

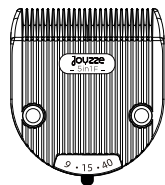

FINE-Adjustable Blade

Fine blade: 0.5 - 1.0 - 1.6 - 2.2 - 2.8 mm
 Size adjustable: 40 - 30 - 15 - 10 - 9

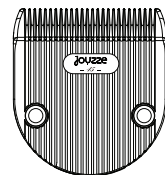

#45

Non-Adjustable blade: 0.5mm 1/50"

Non-Adjustable Blades

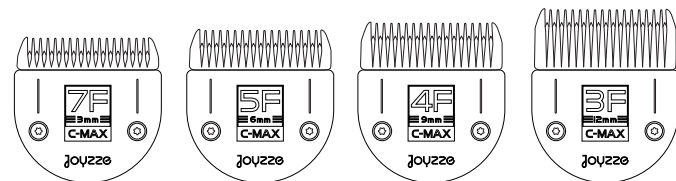

Material

Comb blade: 440C Stainless steel
 Shear blade: Proprietary coated ceramic

Blade Length Adjustment Operation

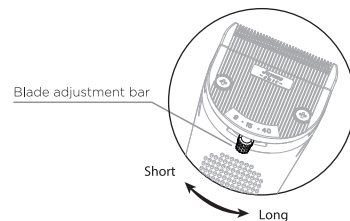

Joyzze blades work with most 5-in-1 style clippers

Clipper Combs

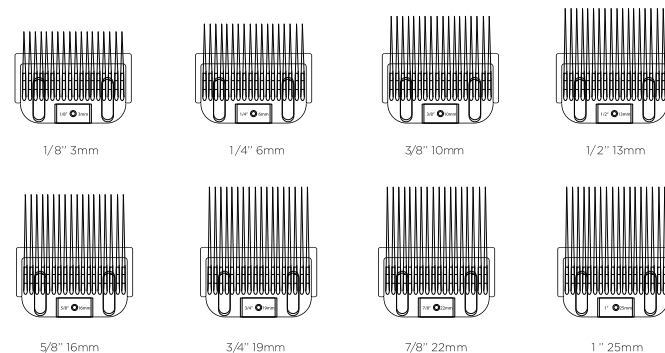

- Work perfectly with most 5-in-1 style clippers.
- * Please adjust the FINE blade to the 30 or 40 position when using combs.
- * Please adjust the STANDARD blade to the 15 or 30 position when using combs.

For best results use on untangled brushed hair.

8 Piece Metal Guard Combs Set (item #: 0214)

Joyzze Hornet clipper can be customized with unique front cover designs. These covers can easily be replaced at anytime for a fresh new look.

For more information visit Joyzze.com



WARRANTY REGISTRATION CARD

Register your product within 30 days of purchase to activate its 12-month warranty. Warranty valid only when this card is completed and returned within 30 days of purchase.

Register online at Joyzze.com or mail in the following:

REQUIRED WITH REGISTRATION:

- 1. Complete warranty card.
- 2. Proof of purchase. Cut out UPC from product package.
- 3. Copy of receipt.
- 4. Mail to Joyzze, P.O. Box 440098, Kennesaw, GA 30160

IF RETURNING FOR REPAIR SERVICE:

- 1. Submit the Required with Registration information if not already registered.
- 2. Pack clipper in bubble wrap to protect during shipping.
- 3. Enclose a return fee of \$15.00 USD.

Salon / Customer's Name:				
Address:	Telephone:			
	Email:			
	Date of Purchase (MM/DD/YY):	Serial or Batch #:		
Store / Distributor's Name:	City:	State:		

IMPORTANT SAFETY INFORMATION

When using an electrical appliance, basic precautions should always be followed, including the following:

Read all instructions before using your Joyzze clipper.

DANGER: To reduce the risk of electric shock:

- 1. Avoid placing or storing clipper near water or other liquids.
- 2. Do not use if clipper, plug, or charging stand has been immersed in water or other liquid.
- 3. Unplug immediately if clipper falls into water or another emergency occurs.
- 4. Unplug cord from outlet and clipper except when charging.
- 5. Turn clipper off and unplug cord from outlet before cleaning or changing parts.

WARNING: To reduce the risk of fire, electric shock, or personal injury:

- 1. Clipper should never be left unattended when plugged in.
- 2. Supervision is necessary when used by, on, or near children or individuals with certain disabilities.
- 3. Use this clipper only for its intended use. Do not use attachments not recommended by Joyzze.
- 4. Do not use this clipper if cord or plug is damaged, if it is not working properly, if it has been dropped, or immersed in any liquid. Return to Joyzze for repair.
- 5. Do not use an extension cord with this clipper.
- 6. Keep the cord away from heated surfaces.
- 7. For indoor use only. Do not use around aerosol products or where flammable gasses, such as oxygen, are in use.
- 8. To avoid injury: never use this clipper with a damaged or broken blade or comb.
- 9. To disconnect: turn control to OFF then remove plug from outlet.
- 10. Use only the charging stand supplied by Joyzze to recharge.
- 11. This clipper is not intended for use by children or persons with reduced physical, sensory or mental capabilities, or lack of experience and knowledge, unless they have been given supervision or instruction concerning use of the appliance by a person responsible for their safety.
- 12. Remove battery before disposing of product.
- 13. Dispose of battery properly and safely.

KEEP OUT OF REACH OF CHILDREN